

**LEGEND**

- LIMITED ACCESS HIGHWAY
- STATE ROUTE AND NUMBER
- STATE MAINTAINED BRIDGE ON TOWNSHIP ROAD
- TOWNSHIP ROAD, NUMBER AND SEGMENT LENGTH IN MILES
- - - IMPASSABLE TOWNSHIP ROAD
- TURNBACK TOWNSHIP ROAD
- OTHER ROAD
- RAILROAD (IN SERVICE)
- RAILROAD ABANDONED (TRACK RETAINED)
- - - STATE BOUNDARY
- - - COUNTY BOUNDARY
- - - TOWNSHIP BOUNDARY
- - - CITY OR BOROUGH BOUNDARY
- MUNICIPAL BUILDING
- SPLIT MILEAGE BETWEEN MUNICIPALITIES

- 321 EWART RD
- 323 WOODWARD RD
- 324 NINE GATES RD
- 325 LESLIE RD
- 326 CEDARCROFT RD
- 327 MILL RD
- 328 BURROWS RUN RD
- 329 NORTH WALNUT ST
- 330 BUTTWOOD LA
- 331 HAMORTON CUTOFF
- 333 BUCKTOE RD
- 337 HILLEDALE RD
- 339 CENTER HILL RD
- 341 SOUTH ST
- 343 SILLS MILL RD
- 345 FERBERTON RD
- 406 SCARLETT RD
- 408 CHANDLER MILL RD
- 420 WICKHAM LN
- 422 COPE RD
- 423 LONGWOOD DR
- 424 ORCHARD DR
- 426 BAYARD RD
- 432 GREENWOOD RD
- 434 DEER PATH
- 597 WALWOOD DR
- 598 MCCARTHY RD
- 599 ROUNDHILL RD
- 600 HILLTOP DR
- 601 ELMWOOD DR
- 602 OAK LA
- 603 DOGWOOD DR
- 604 HOLLY DR
- 605 HANNU RD
- 606 DEERFIELD LA
- 607 PATRICIA LA
- 608 HUNTSMAN'S PATH
- 609 WOODCHUCK WAY
- 610 TURKEY HOLLOW RD
- 611 POSSUM TREE LA
- 612 CHIPMUNK LA
- 613 FAIRHORN ST
- 614 FANN LA
- 615 RING TAIL RUN
- 616 WOODS LA
- 617 BUSH LA
- 618 WILLIAMS DR
- 619 WILKWOOD DR
- 620 PENN OAK LA
- 621 HILL SPUR DR
- 622 SOUTHRIDGE DR
- 623 MARSHALL BRIDGE DR
- 624 CEDARWOOD LA
- 625 WHITETAIL DR
- 626 FAIRVILLE RD
- 627 NORWAY RD
- 628 ROSEDALE RD
- 629 COLD SPRINGS DR
- 630 WILLOW GLEN DR
- 631 WILLOW GLEN CIR
- 632 MONTBEARD DR
- 633 NORBANDY DR
- 634 HILLINGHAM CT
- 635 CLAYTON CT
- 636 MILLBROOK DR
- 637 WHITNEY DR
- 638 CLIFFTON DR
- 639 MEADOW VIEW LA
- 640 POND VIEW DR
- 641 ORCHARD VIEW DR
- 642 ORCHARD TER
- 643 BANESWOOD DR
- 644 BANESWOOD CIR
- 645 KNOWLIN FARM DR
- 646 MONTANA DR
- 647 SKYVIEW LA
- 648 DAVENPORT RD
- 649 DONNY RD
- 650 STONEPINE DR
- 651 YORKTOWN DR
- 652 WESTOVER AV
- 653 CAMBRIDGE CIR
- 654 CANTERBURY DR
- 655 CAPTAIN ROBINSON DR
- 656 GREGG LA
- 657 MOYNAHAN LA
- 658 INDIAN SPRINGS DR
- 659 BALMORAL DR
- 660 EDINBURGH RD
- 661 REGENTS CT
- 662 MILL RACE RD
- 663 OVERBROOK DR
- 664 TWIN CREEK LA
- 665 ORIOLE DR
- 666 WREN LA
- 667 FALCON DR
- 668 QUAIL LA
- 669 RAVEN DR
- 670 WALNUT VALLEY RD
- 671 KENNETT RIDGE DR
- 672 SEAN DR
- 673 PEACOCK LA
- 674 HARI DR
- 675 BURROWS MILL RD
- 676 LERTILLA LA
- 677 ASHFORD DR
- 678 KODDALE DR
- 679 SANDY FLASH DR
- 680 LAVENDER DR
- 681 ADDORIDGE DR
- 682 ADDORIDGE ROAD SPUR A
- 683 ADDORIDGE ROAD SPUR B
- 684 ADDORIDGE ROAD SPUR C
- 685 BLUE SPRUCE DR
- 686 FOOTHILL DR
- 687 FOREST DR
- 688 PIN OAK DR
- 689 RICHARDSONS BROOK DR
- 690 SASSAPRAS DR
- 691 SUGAR MAPLE DR
- 692 VIBURNUM DR
- 693 ADDOVIER DR
- 694 EAST BRANCH DR
- 695 RED CLAY DR
- 696 FALLBROOKE DR
- 697 KESWICK CT
- 698 MARC DR
- 700 FULLING DR
- 701 CARLTON DR
- 702 WOODEN POND DR
- 703 PENNFIELD DR
- 704 PENNS MANOR DR
- 705 ELIZABETH DR
- 706 PIERCE LA
- 707 BURN MILL CIR
- 708 BLACK ROCK RD

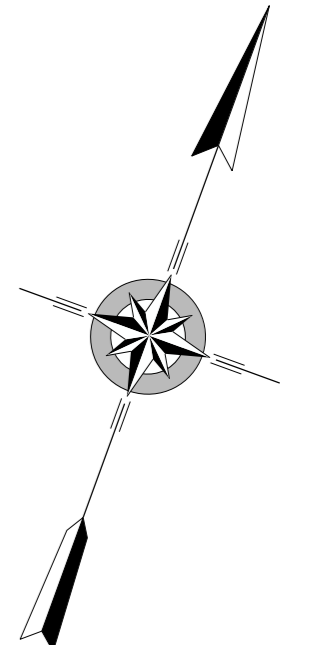
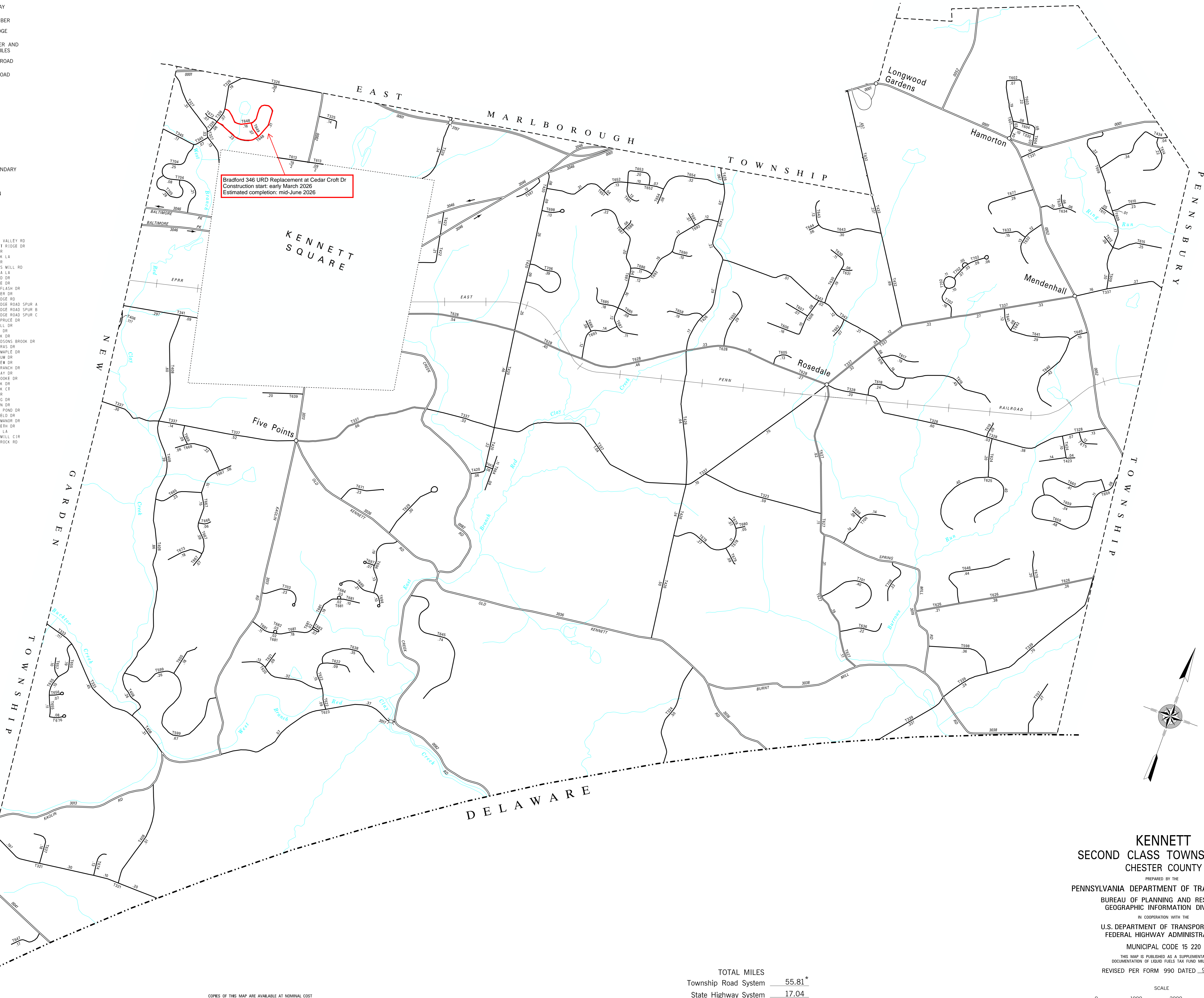

**KENNETT  
SECOND CLASS TOWNSHIP MAP  
CHESTER COUNTY**

PREPARED BY THE  
PENNSYLVANIA DEPARTMENT OF TRANSPORTATION  
BUREAU OF PLANNING AND RESEARCH  
GEOGRAPHIC INFORMATION DIVISION  
IN COOPERATION WITH THE  
U.S. DEPARTMENT OF TRANSPORTATION  
FEDERAL HIGHWAY ADMINISTRATION  
MUNICIPAL CODE 15 220  
THIS MAP IS PUBLISHED AS A SUPPLEMENTAL  
DOCUMENTATION OF LIQUID FUELS TAX FUND MILEAGES  
REVISED PER FORM 990 DATED 9-6-18

TOTAL MILES	
Township Road System	55.81*
State Highway System	17.04
Total	72.85

\* Includes ACT 32 Turnback Mileage of 6.30

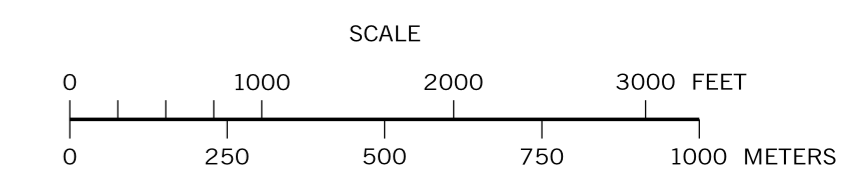

COPIES OF THIS MAP ARE AVAILABLE AT NOMINAL COST  
CONTACT:  
PENNSYLVANIA DEPARTMENT OF TRANSPORTATION  
SALES STORE  
P.O. BOX 3463  
HARRISBURG, PENNSYLVANIA 17105-3463  
TELEPHONE: (717)763-6746

POPULATION 8,289  
(2020 Census)